

BLEED VALVE

The bleed valve is a part of the pilot line. The device must be mounted at the end of each pilot line at the last pneumatic release device. This device is a security part, which protects the system from unwanted tripping when a cylinder has a leak and the pressure would increase in the pilot line. It allows a bleeding till the pressure in the pilot line is under 0.7 Bar. The bleed valve prevents an accidental system release.

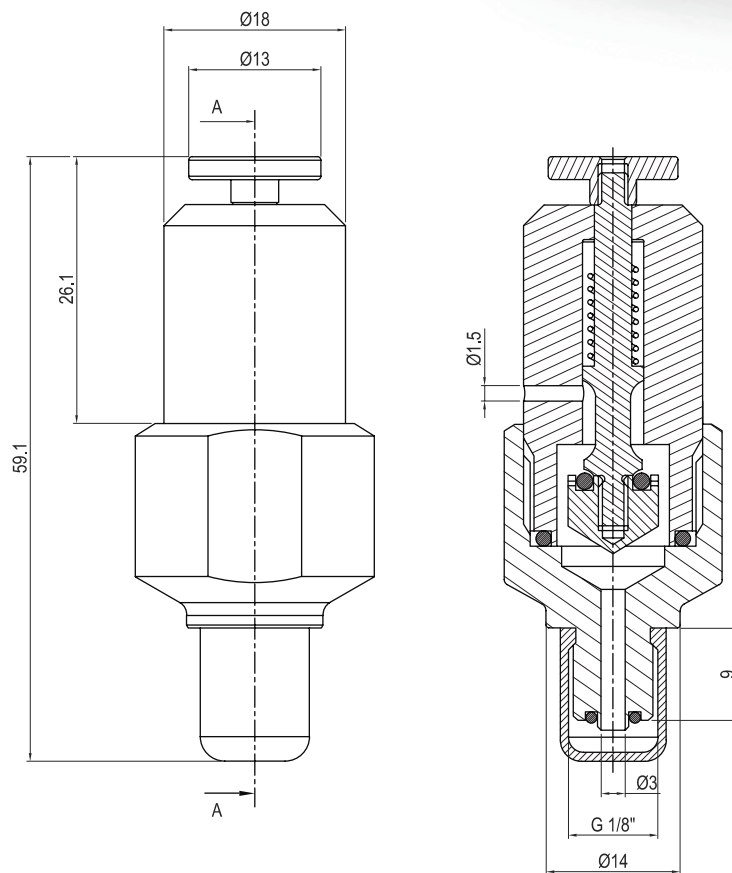

SPECIFICATION

Model No	029730040-NF
Material	Brass
Working Pressure	360 Bar
Connection Thread	G1/8" DIN ISO 228-1
Nominal Diameter	DN 1.5
Closing Pressure	0.7 - 1.5 Bar



NAFFCO
 Email: info@naffco.com
www.naffco.com

In line with NAFFCO policy for continuous product development, NAFFCO has the right to change specifications without prior notice.