

# DISCHARGE NOZZLE

Discharge nozzles are made of brass in four different sizes, for different application. Nozzles are available with a connection thread R1½", R1", R¾" and R¾" and can be screwed into every fitting corresponding to the pressure stage and the thread. Orifice design to particular requirement with computer aided calculation to assure the effectiveness of extinguishing agent and reliable system design.

The nozzle is used to discharge the agent from the cylinder through piping network to the enclosed hazard volume. The nozzle selection

depends on the hazard and location to be protected. The nozzle has to be mounted at the ceiling level with the orifice tip pointed vertically down. The nozzle outlet must point downwards to distribute the extinguishing agent effectively and to prevent pollution. The discharge pattern of the nozzle shall be 360°.

The nozzle distributes the extinguishing agent evenly in the extinguishing zone in the calculated flooding time. Nozzles are designed to direct the discharge of inert gas using the stored pressure from the cylinders.

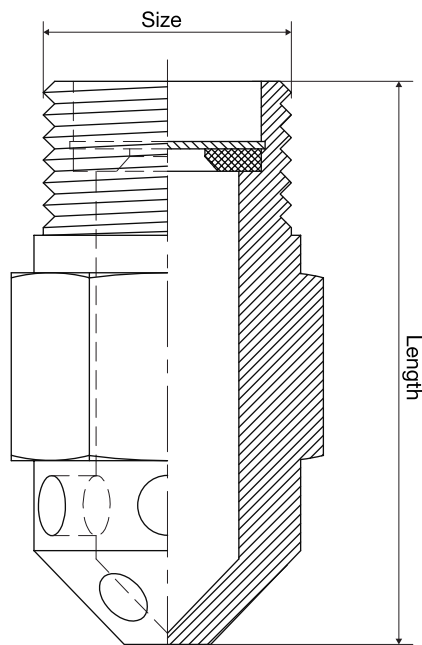

| SPECIFICATION  |            |             |              |              |
|--|------------|-------------|--------------|--------------|
| Size   | R1½"       | R¾"         | R1"          | R¾"          |
| Thread   | EN 10226-1 |             |              |              |
| Orifice Diameter   | Ø3-Ø9.5 mm | Ø7-Ø13.5 mm | Ø10-Ø17.5 mm | Ø15-Ø25.5 mm |
| Material   | Brass      |             |              |              |
| Working Pressure   | 60 Bar     |             |              |              |
| The orifice diameter is defined with flow calculation software |            |             |              |              |

## ORDERING INFORMATION

| Connection Thread    | Model Number | Orifice Diameter | Model Number | Orifice Diameter |
|----------------------|--------------|------------------|--------------|------------------|
| R½" DIN EN 10226-1   | BO4611100-NF | 3 mm             | BO4611107-NF | 3.5 mm           |
|                      | BO4611101-NF | 4 mm             | BO4611109-NF | 4.5 mm           |
|                      | BO4611102-NF | 5 mm             | BO4611110-NF | 5.5 mm           |
|                      | BO4611103-NF | 6 mm             | BO4611111-NF | 6.5 mm           |
|                      | BO4611104-NF | 7 mm             | BO4611112-NF | 7.5 mm           |
|                      | BO4611105-NF | 8 mm             | BO4611113-NF | 8.5 mm           |
|                      | BO4611106-NF | 9 mm             | BO4611114-NF | 9.5 mm           |
| R¾" DIN EN 10226-1   | BO4611200-NF | 7 mm             | BO4611208-NF | 7.5 mm           |
|                      | BO4611201-NF | 8 mm             | BO4611209-NF | 8.5 mm           |
|                      | BO4611202-NF | 9 mm             | BO4611210-NF | 9.5 mm           |
|                      | BO4611203-NF | 10 mm            | BO4611211-NF | 10.5 mm          |
|                      | BO4611204-NF | 11 mm            | BO4611212-NF | 11.5 mm          |
|                      | BO4611205-NF | 12 mm            | BO4611213-NF | 12.5 mm          |
|                      | BO4611206-NF | 13 mm            | BO4611214-NF | 13.5 mm          |
| R1" DIN EN 10226-1   | BO4611300-NF | 10 mm            | BO4611309-NF | 10.5 mm          |
|                      | BO4611301-NF | 11 mm            | BO4611310-NF | 11.5 mm          |
|                      | BO4611302-NF | 12 mm            | BO4611311-NF | 12.5 mm          |
|                      | BO4611303-NF | 13 mm            | BO4611312-NF | 13.5 mm          |
|                      | BO4611304-NF | 14 mm            | BO4611313-NF | 14.5 mm          |
|                      | BO4611305-NF | 15 mm            | BO4611314-NF | 15.5 mm          |
|                      | BO4611306-NF | 16 mm            | BO4611315-NF | 16.5 mm          |
|                      | BO4611307-NF | 17 mm            | BO4611316-NF | 17.5 mm          |
| R1 ½" DIN EN 10226-1 | BO4611400-NF | 15 mm            | BO4611412-NF | 15.5 mm          |
|                      | BO4611401-NF | 16 mm            | BO4611413-NF | 16.5 mm          |
|                      | BO4611402-NF | 17 mm            | BO4611414-NF | 17.5 mm          |
|                      | BO4611403-NF | 18 mm            | BO4611415-NF | 18.5 mm          |
|                      | BO4611404-NF | 19 mm            | BO4611416-NF | 19.5 mm          |
|                      | BO4611405-NF | 20 mm            | BO4611417-NF | 20.5 mm          |
|                      | BO4611406-NF | 21 mm            | BO4611418-NF | 21.5 mm          |
|                      | BO4611407-NF | 22 mm            | BO4611419-NF | 22.5 mm          |
|                      | BO4611408-NF | 23 mm            | BO4611420-NF | 23.5 mm          |
|                      | BO4611409-NF | 24 mm            | BO4611421-NF | 24.5 mm          |
|                      | BO4611410-NF | 25 mm            | BO4611422-NF | 25.5 mm          |



**NAFFCO**  
 Email: [info@naffco.com](mailto:info@naffco.com)  
[www.naffco.com](http://www.naffco.com)

In line with NAFFCO policy for continuous product development, NAFFCO has the right to change specifications without prior notice.